

Gerber® Taurus 4-Panel Cutting Surface Installation Instructions

Tools required: air nozzle, hot melt glue gun, chisel or scraper, razor knife

1. Remove old panels. Blow out debris from vacuum grid, clean aluminum side rails.

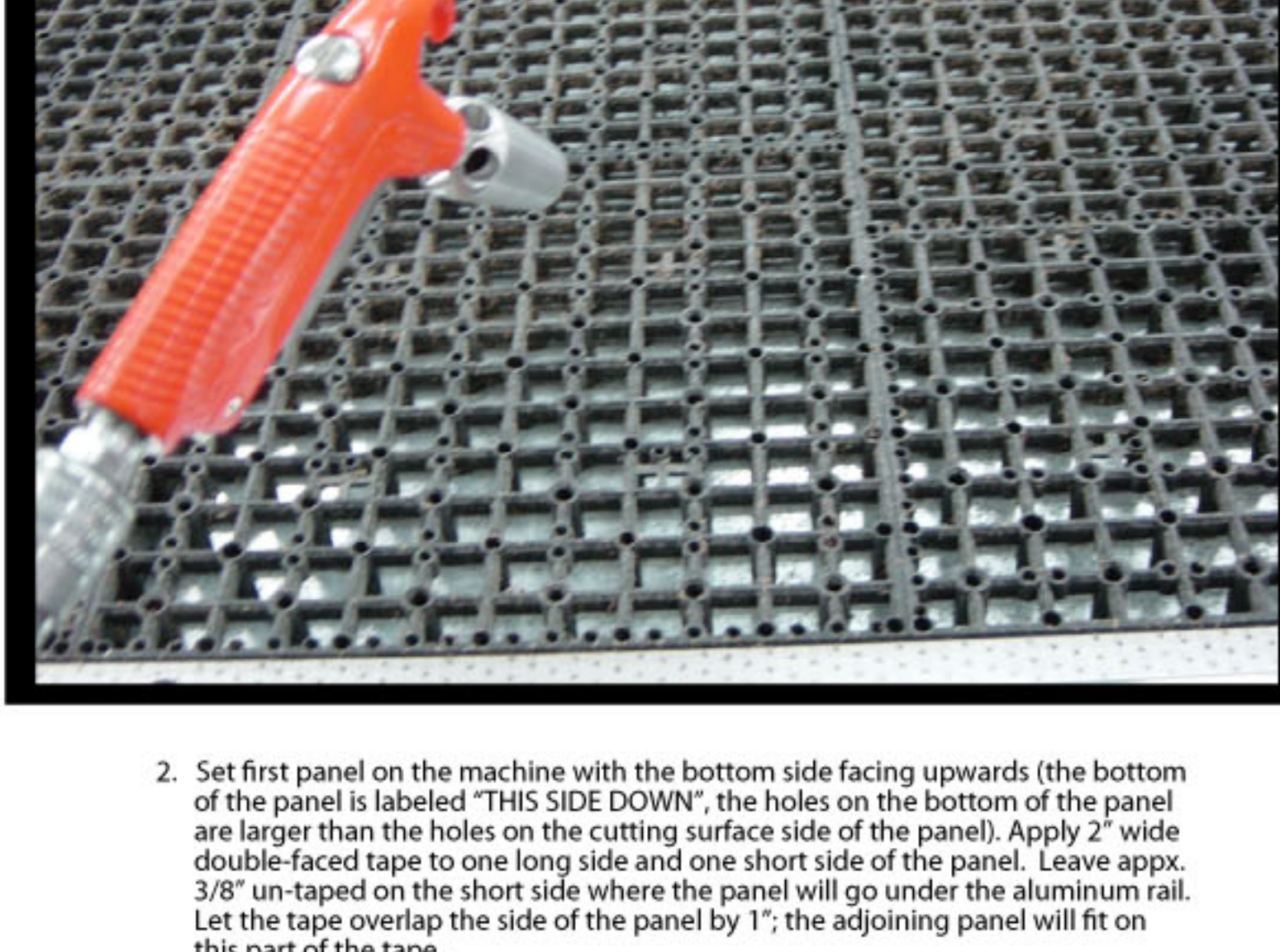

2. Set first panel on the machine with the bottom side facing upwards (the bottom of the panel is labeled "THIS SIDE DOWN", the holes on the bottom of the panel are larger than the holes on the cutting surface side of the panel). Apply 2" wide double-faced tape to one long side and one short side of the panel. Leave approx. 3/8" un-taped on the short side where the panel will go under the aluminum rail. Let the tape overlap the side of the panel by 1"; the adjoining panel will fit on this part of the tape.

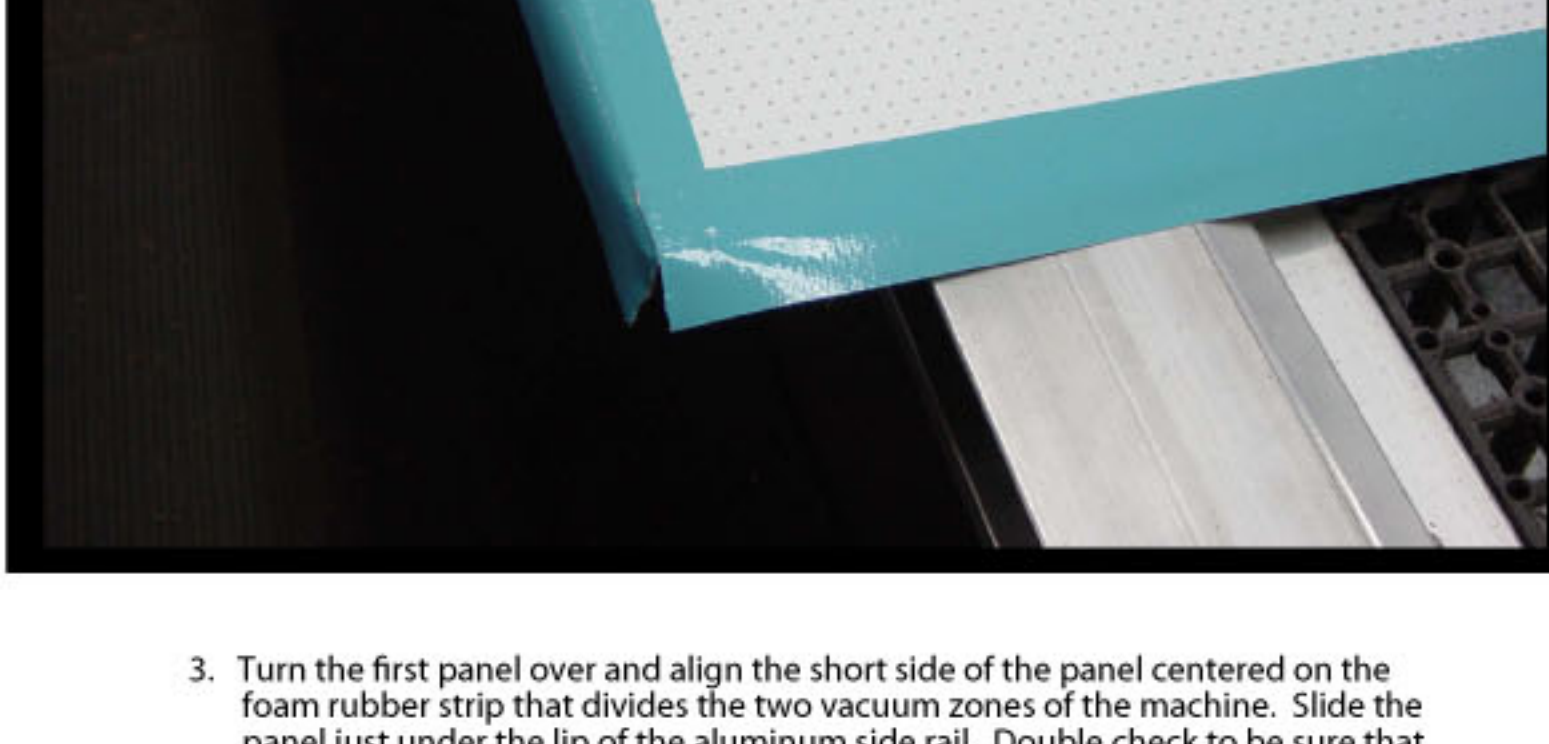

3. Turn the first panel over and align the short side of the panel centered on the foam rubber strip that divides the two vacuum zones of the machine. Slide the panel just under the lip of the aluminum side rail. Double check to be sure that the panel is still parallel to the aluminum side rail and that it is also centered on the vacuum zone divider. Remove the backing from the other side of the double-faced tape (alternatively you can remove the facing from the double faced tape before turning the panel over).

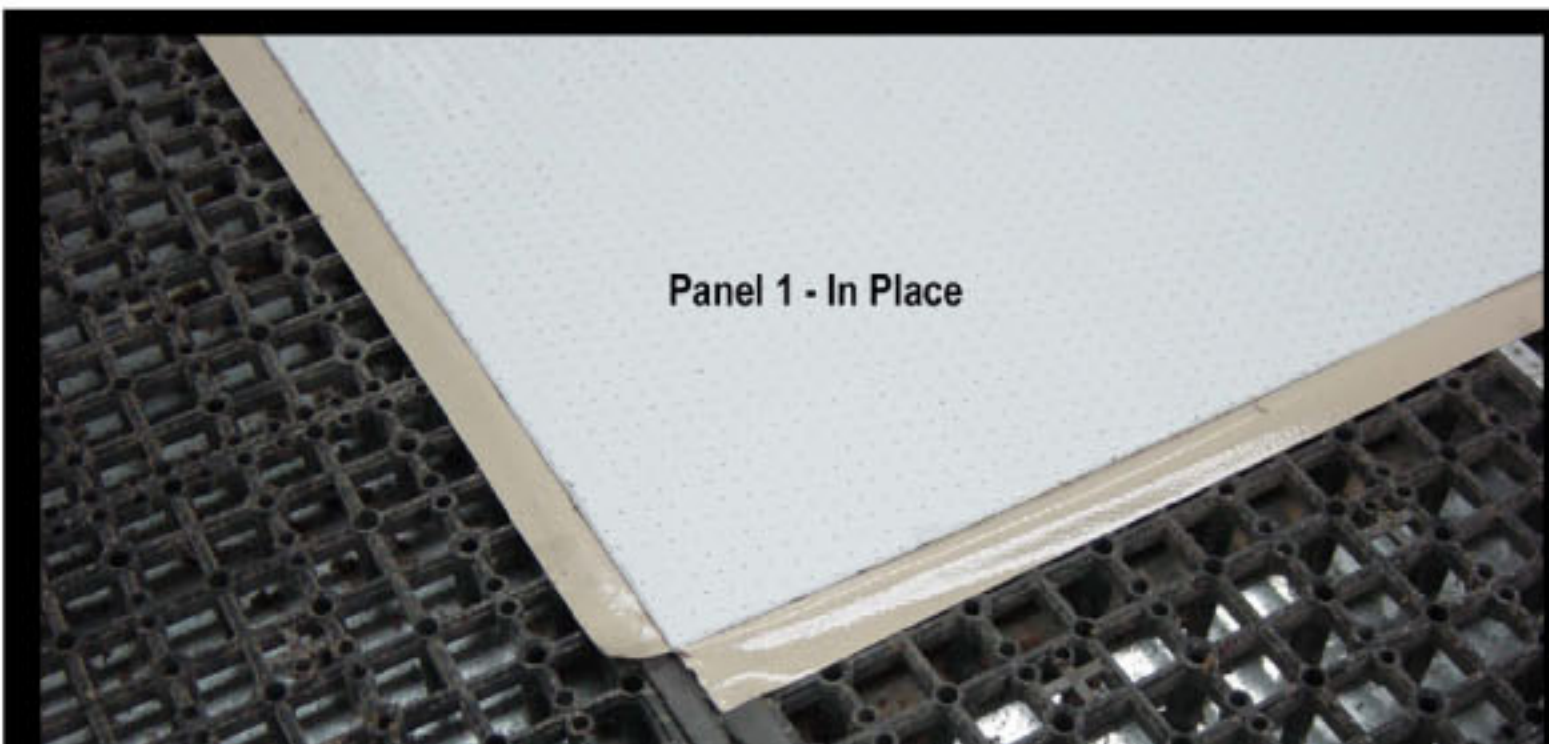
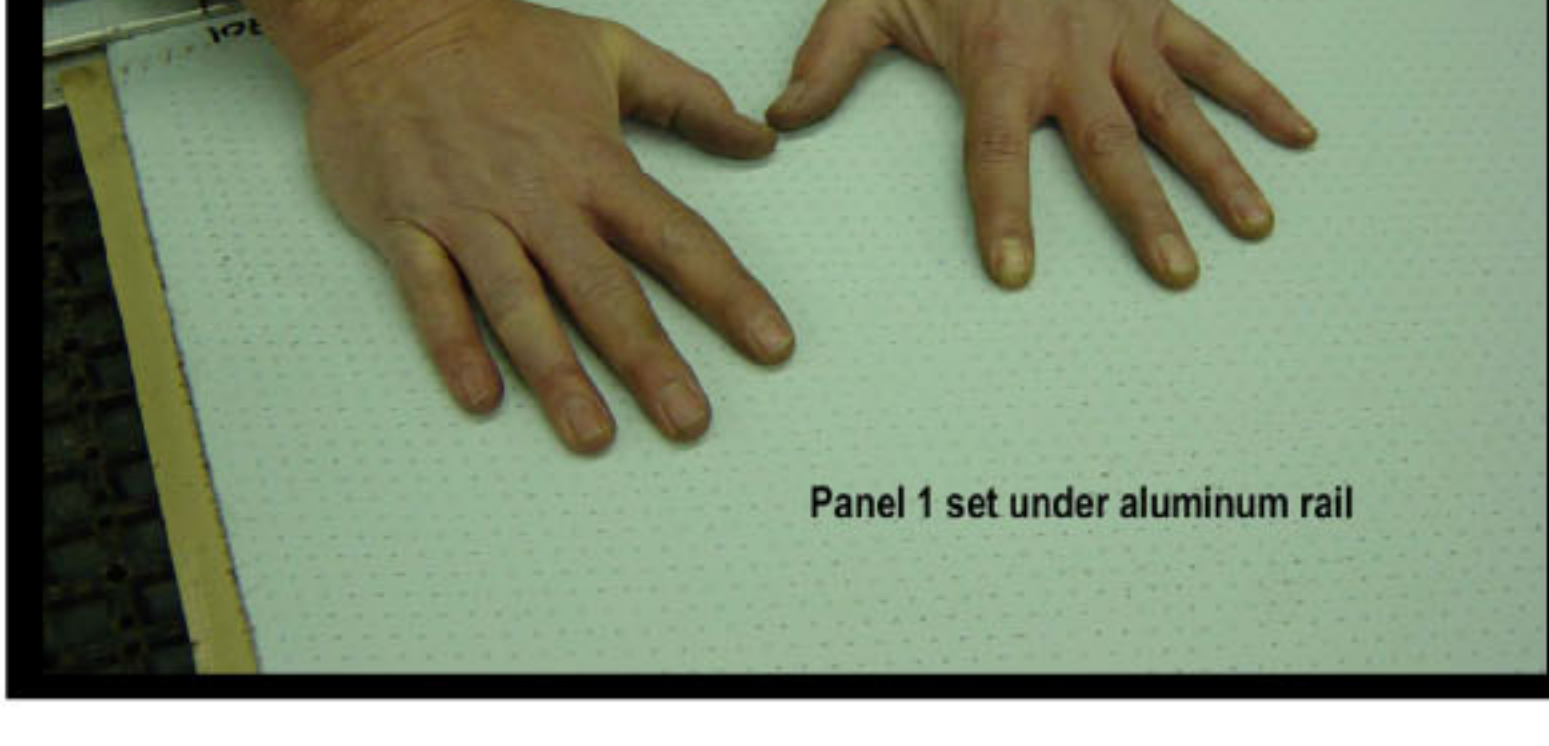

4. Place panel two on machine with the bottom facing upward and apply the double- faced tape to only one of the short ends. This panel will mate with the long side of panel one. Carefully turn the panel over and insert the edge just under the lip of the aluminum rail while at the same time aligning the short end (with the tape) on the center of the vacuum zone divider and the edge of the first panel. The gap between the two panels should be about 1/16" (approximately the thickness of a quarter) up to a maximum of 1/8". After the two panels are in place, a slight adjustment may be necessary so that both long sides of the panels are under the aluminum rail. When the panels are in place, press the joint down for good adhesion to the tape.

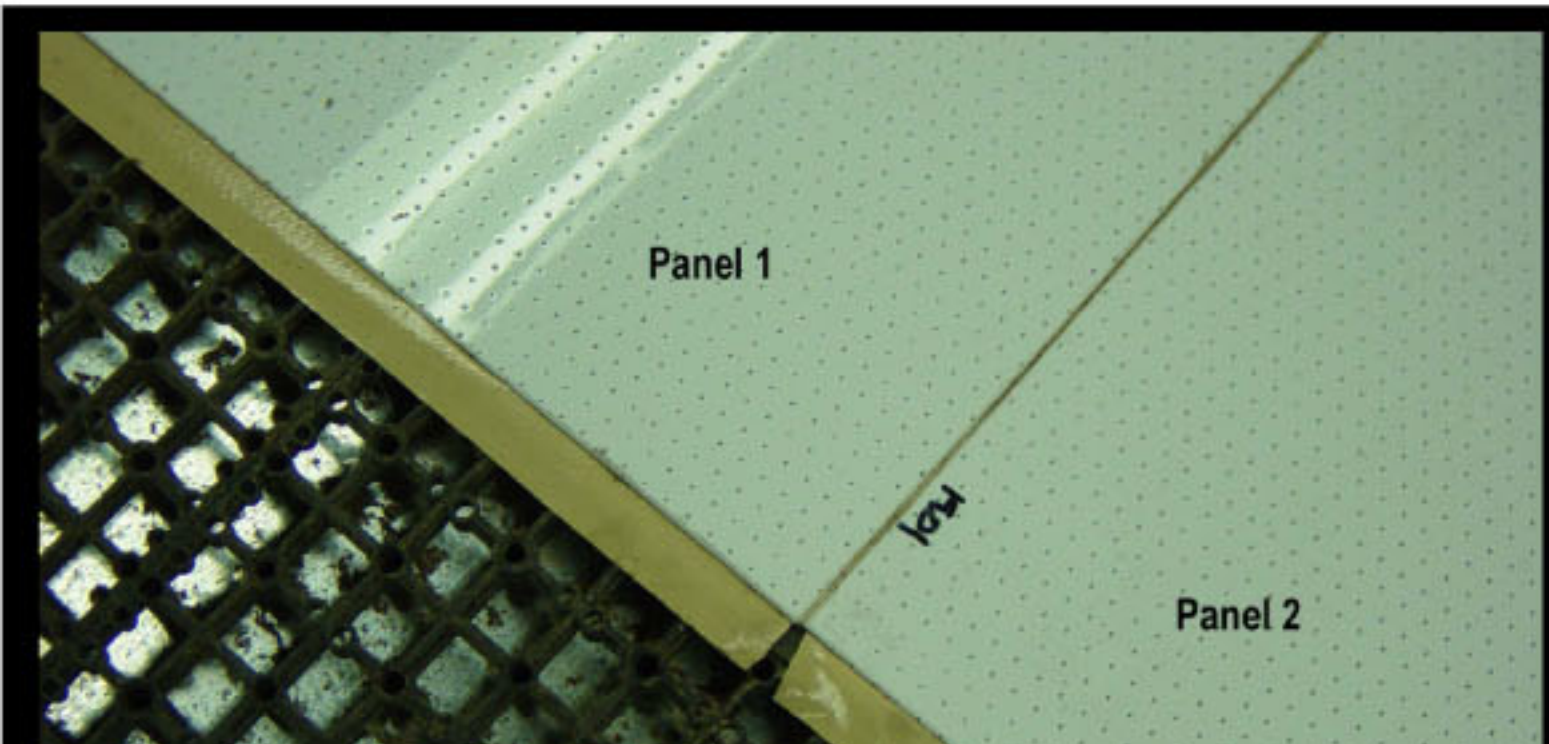

5. Place panel three on machine as above and apply the tape to one long side only. Install the panel as above.

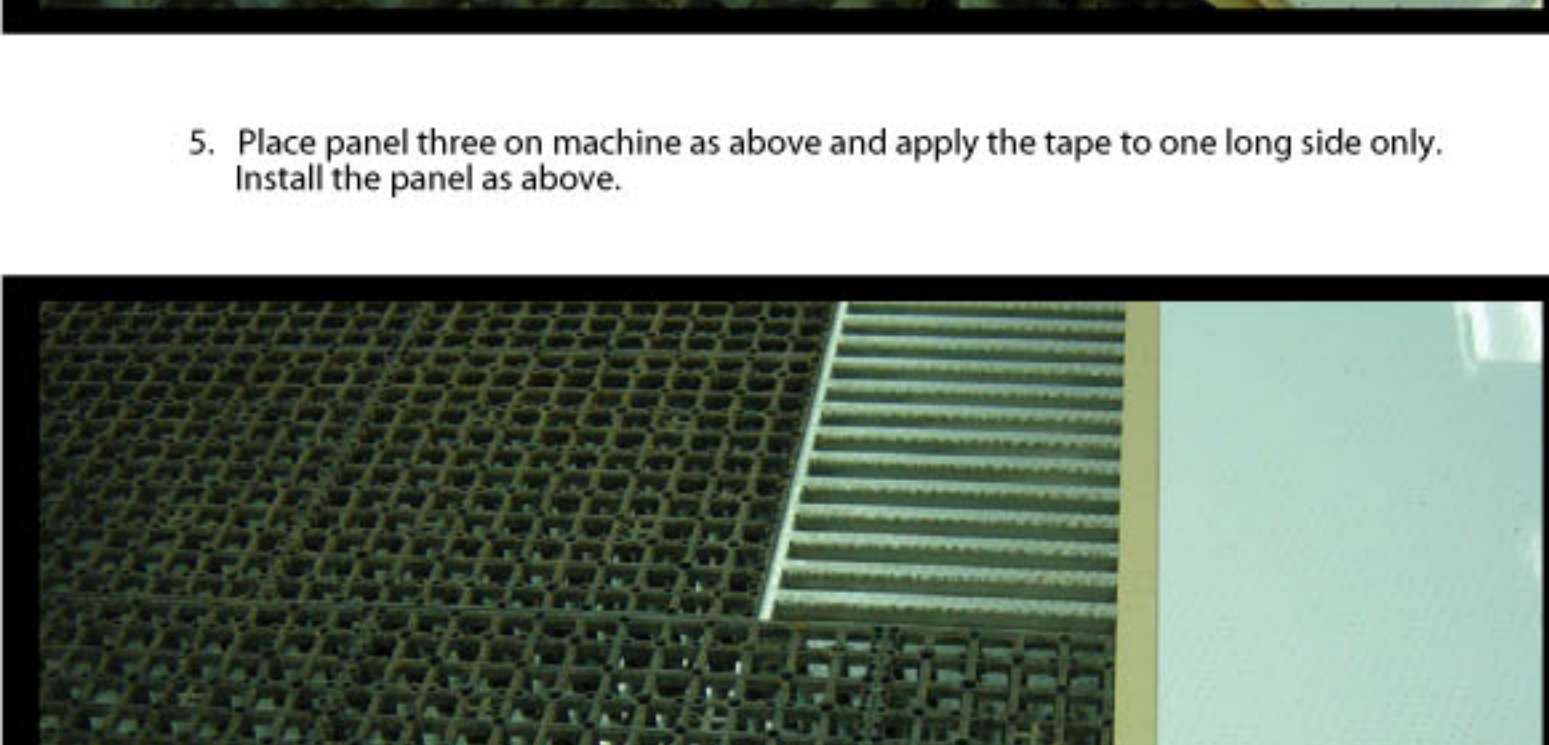

6. Panel four does not require any tape. Place it on machine as above and press down the joints after it is in position.

7. At this point the panels should be laying flat on the machine with the edges slightly under the aluminum rail.

8. Apply the hot melt glue to the joints. Be liberal with the glue so that it goes completely into the joint and leaves a bead on top of the panels. The edges of the panels are slightly chamfered so that the glue will provide a lock as it flows under the chamfered edge of the panel.

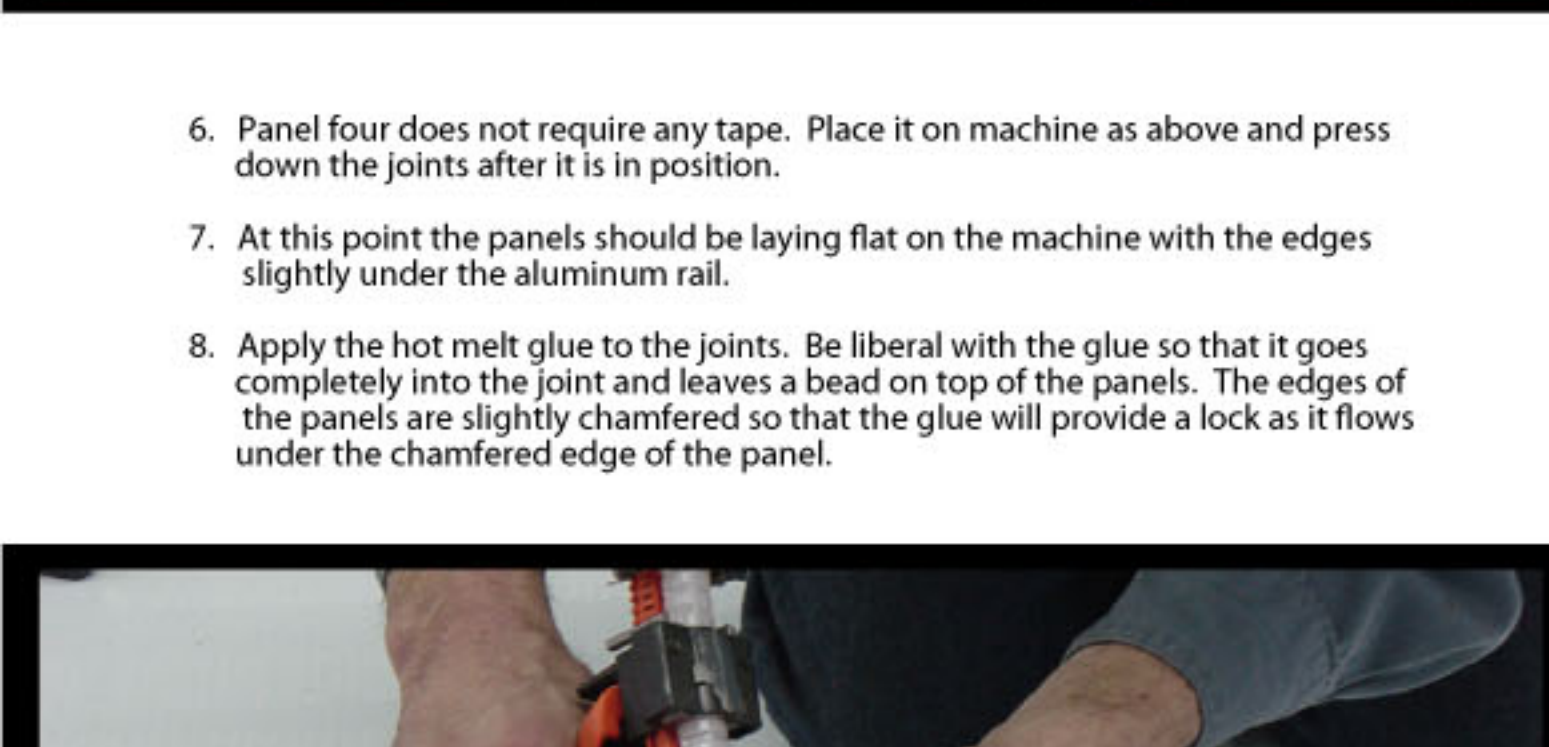

9. Before the glue completely cools, remove the excess glue from the surface of the panels; a wood chisel works well (fully cured glue is difficult to remove).

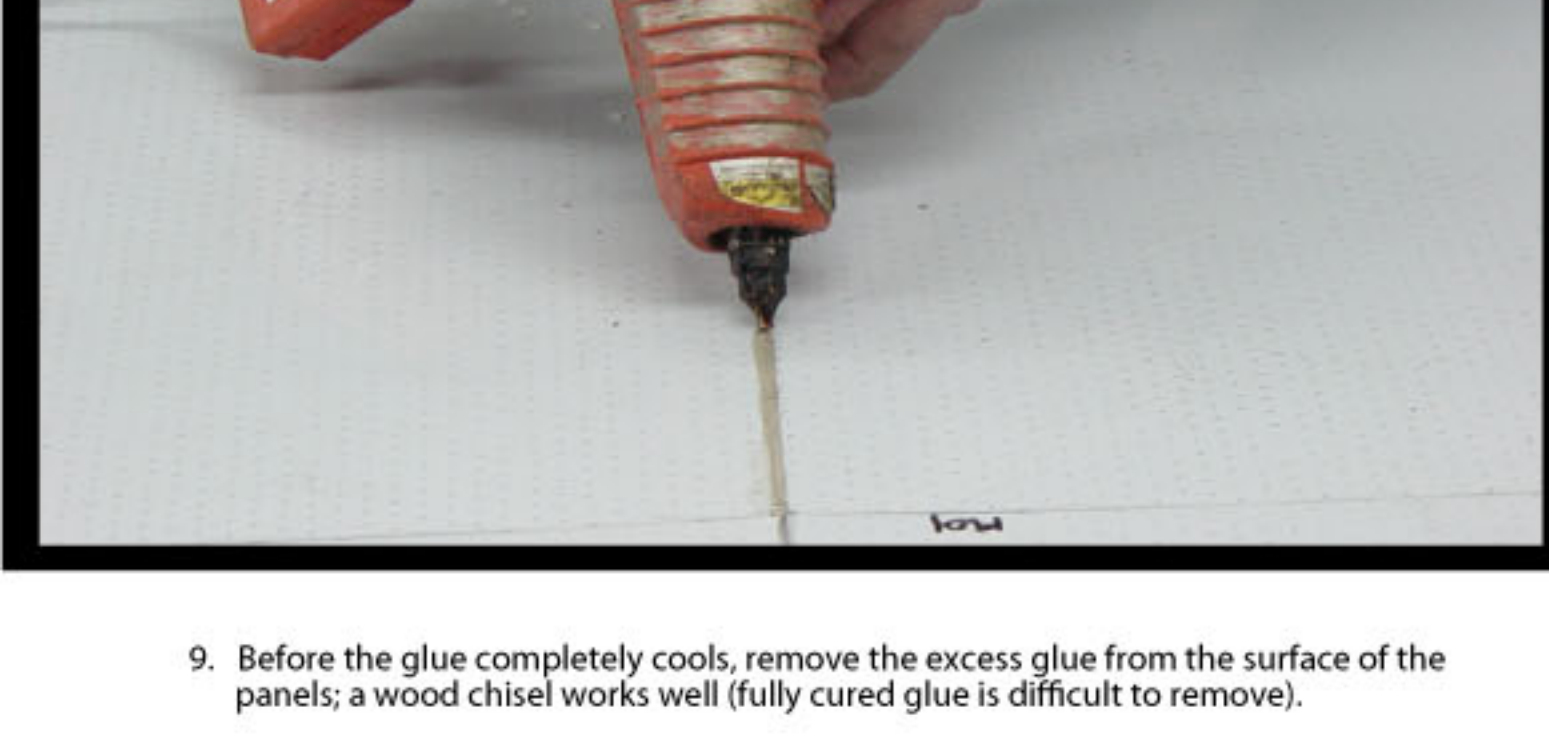

10. Reapply any cutting zone reference marks as required.



11. The edges of the panels at both ends of the machine can be sealed with tape if desired or if vacuum leaks are present.

12. The installation of the panel system is complete. Check and calibrate the machine tooling and reference marks as required.



The installation is now complete.

For installation help, please call 828-327-8442